

Turning Times

THE OFFICIAL NEWSLETTER OF THE CASCADE WOODTURNERS

July 2011

Please make sure that all content for the next newsletter reaches me by the 4th of August! rgklug@crestviewcable.com Thanks!

**NEXT MEETING: 10:00AM, SATURDAY, JULY 23rd AT Phil Lapp's Hazel Nut Farm
17400 SW Brookman Rd, Sherwood, OR**

PRESIDENTS MESSAGE

Presidents Corner – Ramblings from St. Paul

My wife and I drove 3 days across some beautiful country to attend the Symposium. We came within 12 miles of Minot North Dakota shortly after it had flooded. Across much of Montana, North Dakota and Minnesota we drove over bridges that were close to flooding. After the Symposium we drove south to Texas where they haven't had rain since last year and the lakes and reservoirs are drying up. We saw evidence of the range fires that have occurred across a dozen states of the southwest. I was glad to return home. I counted 8 people from our Cascade group at the AAW Symposium in St. Paul. There could have been some that I missed, but with 1700 people attending and the large number of classes, I couldn't begin to see everyone and everything. (I would hope we have several times that number at next years Symposium in San Jose as it is much closer.) This year there were eleven rotations with 14 classes/activities at each for a total of 154 classes. That isn't counting the various exhibits, instant gallery, special demonstrations, evening meetings and trade show booths. As I said, you can't see it all. I had to take the instant gallery in small doses because it is a visual overload. If you want to see what is possible, it tends to show up here first.

The Minnesota PBS had a film crew at the Instant Gallery set up to do interviews and I wandered over while they were interviewing Dale Larson. I was quite pleased with their location as I realized that my pieces were in the immediate background of their filming. I guess showing up at the last minute of the gallery set-up and winding up at the back of the room has some advantages.

On a sad note, my raffle ticket for the Binh Pho Powermatic Lathe wasn't a winner. Oh well, my wife wouldn't have let me put it in the living room anyway. ☺

Dave Williams

dwilliams97007@yahoo.com

DALE'S CORNER

There will not be open shop in July because of family activities.

AAW Symposium News

- ❖ The symposium in St Paul was the second largest symposium, after Louisville 2006. We had 1713 members come.
- ❖ The youth room had 80 kids turning, twenty five of the kids got to take a lathe home.
- ❖ The live auction brought in \$68,000 and the silent auction more.
- ❖ There were three days of classes by about 45 woodturners from all over the world.
- ❖ The vendor show was full with at least 10 models of lathes for sale. Each year brings new lathes, this year a new one from Belgium.
- ❖ The Painted lathe raffle was very successful. It was won by a member from near Chicago. Sorry to all our members who I sold the winning ticket to.
- ❖ The Instant Gallery covered 70 eight foot tables with over 1700 turned pieces.
- ❖ David and Dan were there along with a good show of members from Tacoma and Seattle.
- ❖ If you would like to see some photos from the Instant Gallery you can go to <http://www.youtube.com/watch?v=07HRxhGZYqA>

Planning is already well under way for the San Jose symposium June 8-10, 2012. This will be as close as it gets to us for another five years so mark your calendar.

Dale

woodbowl@frontier.com

CLUB CRAFT SUPPLY ORDER

Kudos to Skip Burke for managing the Craft Supply club order which was over \$3500. Thirteen members took advantage of the opportunity. Total savings exceeded \$500 from discounts and free shipping.

CASCADE 14 YEARS AGO

Cascade Woodturners meeting on Saturday, July 11 1998 was held at Phil Lapp's farm in Sherwood for a bar-b-que picnic, one of a number of times that Phil and Nancy have graciously opened their home to Cascade for the annual summer picnic. Phil got to show off his new Oneway lathe 1998 officers were: Howard Borer - President, Randy Young - Vice President, Phil Collins - Treasurer and Marquita Green - Secretary. The newsletter was four pages by Laron Thompson and mailed out for a 32 cent stamp!

PICNIC

Cascade Woodturners annual picnic Saturday, July 23rd, 10:00 AM at Phil and Nancy Lapp's filbert farm. If you did not sign up on the initial list for something to bring to the picnic, please e-mail your side dish, salad or desert plan to Nancy Lapp at lapp.nancy@yahoo.com so our hosts will know how many to plan for. Thanks.

Cascade Woodturners will provide the hamburgers, hotdogs, condiments, paper plates, plastic utensils and pop and bottled water. Don't forget to bring a side dish, salad or desert along with your spouse, friend, kid or grandkid. If you want something else to drink please bring that. (Please, no alcoholic beverages)

Phil is providing a gas barbeque but we may need to recruit some relief chiefs grilling the burgers. If anyone has a readily portable bar-b-que, please call Phil Lapp to arrange additional grill space or we can eat in shifts.

All of the tables Phil and Nancy have will be used to put food out. If you have a portable picnic table that would be a great help. Please bring your own lawn chairs.

Phil has ordered such a sunny day that he will set up a 20'x20' tent so there will be shade or cover in case of rain.

Turning entertainment will be an inside out turning challenge. Phil will have his sawmill available if anyone wants to slab some wood, about 20" diameter max by 8' long. He will also have some hazelnut trees available if anyone wants to cut them up. (There is also some Ash fire wood if anyone wants it).

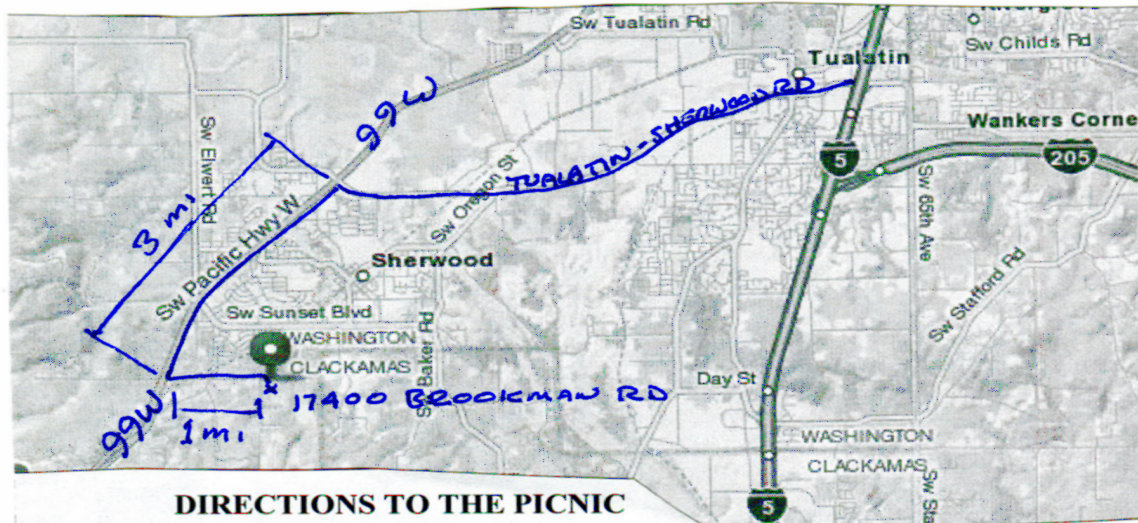

DIRECTIONS TO THE PICNIC

Exit I-5 at the Nyberg/Sherwood/Tualatin exit (Just north of I-205)
 Proceed west on the Tualatin-Sherwood Rd to the Albertsons Shopping Cntr
 Turn left onto 99W and travel about 3 miles
 Turn left onto Brookman Rd
 Travel east one mile.
 Phil's drive is the first right after SW Oberst Rd.

MONTHLY CHALLENGE

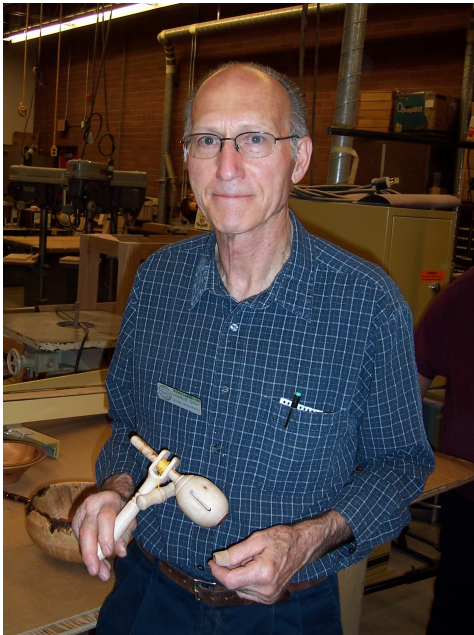

The challenge for June was to turn a kinetic object. This was a big challenge as Charlie Gray was the only one who did it. His spinning top was the winner not only for being the only entry but it is also a nice turning. Congrats Charlie.

Bring an edible item for the July meeting.

JUNE DEMO



David Williams was fatally bitten with the inside out turning bug after reading the article in American Woodturner, February 2010 issue, by Peter Exton. David has persevered to learn what is required for a six diamond turning and showed how at the June meeting. There are a lot of tips and tricks that David shared and to top it off, he has devised a turning challenge of inside out turning for the demo at the picnic.

MEETING SCHEDULE 2011

DATE	DEMONSTRATOR	CHALLENGE
JUL 23	Picnic	Picnic
AUG 18	Graham Priddle	A Plate
SEP 15	Avelino Samuel	Fit in 35mm Film Canister
OCT 20	Auction	Something Tall
NOV 17	Mark Gardener	Christmas Ornaments

For those summer bike rides: 1 million bicycles = 1 megacycle

SKILL BUILDERS

This month I am asking for information on diamond or CBN wheels for sharpening turning tools. Do you lubricate the wheels and if not have you experienced any loss of grinding ability? I will keep collecting information and let you know what information is exchanged in a later newsletter. Jerry Klug

AMAZING TREES



Anyone that has attended an “Open Shop” Saturday in Dale Larson’s shop has seen the culprits on the wall. These are the variety of items that Dale has discovered buried in the wood he is chain sawing or turning. This month’s web site shows a collection of 110 trees that have interesting items in them. Be sure to page through the entire collection so you can appreciate the ability of a tree to absorb its surroundings.

<http://hungrytrees.com>

SYMPOSIUM SCHEDULE

- Woodturners of Olympia Symposium, Olympia WA July 23rd
- SWATurners Symposium, Waco TX August 26th – 28th
- Rocky Mountain Woodturning Symposium, Loveland CO Sept 11th – 12th
- Yellowstone Woodturners Symposium, Billings, MT October 1st & 2nd
- North Carolina Woodturners Bi-Annual Symposium, Greensboro NC Nov 4th – 6th

DEMOS - CLASSES – SEMINARS

Rockler Woodworking 503-672-7266, www.rockler.com

- Contact store for details

Woodcraft 503-684-1428, www.woodcraft.com

- Pen Turning (\$40) by George Hays, July 16th 10:00-1:00
- Beginning Lathe Turning (\$105) by Bob Tuck, July 30th 10:00-4:00
- Basic Bowl Turning (\$105) by Bob Tuck, July 31st 10:00-4:00
- Pen Turning (\$40) by George Hays, Aug 1st 1:00-4:00

Woodcrafters 503-231-0226, 212 NE 6th Ave, Portland,

www.woodcrafters.us

- Turning a Box w/Lid & Pens by Tom Helzer, July 23rd 10:00-3:00
- Turning a Bowls by Bob Tuck, Aug 27th 10:00-3:00

Northwest Washington Woodturners Camping and Turning Rendezvous

July 8th through 24th 2011

North RV Lot, Kittitas Valley Event Center (Ellensburg Rodeo Grounds)

Fees: Daily camping fee, \$13 per rig for hookups to power and water, \$8 per rig or tent for dry camping. Dumpsite is available nearby.

This is an unstructured camping and outdoor turning get together where like minded folk can relax and share experiences. Bring your own mini lathe and come for as long as you wish during these dates.

Contact Julian Lee - julian.s@comcast.net - Telephone 360 299 2900 to confirm your reservation.

LIBRARIANS CORNER

The club library added a new book by Doc Greene, “Fixtures and Chucks For Woodturning”. Those who have read it are anxious to build some if not many of the home made chucks Doc describes. Even if you do not make your own tooling, this book is a treasure of ideas for holding and supporting turnings. I am sure that this book will be quickly checked out each month so you may have to be patient to get a hold of it. You won’t be disappointed when you do.

Three other books on making your own jigs and chucks are also available from the library. They are “Multi Center Woodturning” by Ray Hopper, “A Guide To Work Holding On The Lathe” by Fred Holder and “Woodturning Full Circle” by David Springett. David even uses Bondo auto body repair epoxy to hold some of his turnings. Any of these books will show new and innovative ways to address holding that odd shape for turning.

COMING ATTRACTIONS

July is the annual picnic that will be held at Phil Lapp’s home.

August – Oregon State Fair request for turning entries.

“We would love to have a big woodturning turnout this year. In 2010...the wood carvers really outnumbered the wood turners. I know that there is some amazing talent...just begging to be shown off. Entry forms need to be in by August 5th and delivery of your items is on Saturday August 20th. I hope to see entries from all of you.”

Neva Hutchinson
Event Coordinator
Oregon State Fair
Neva.Hutchinson@state.or.us
(503)947-3220

See entry requirements and how to get an entry form at the end of this newsletter.

August demonstration will be by Graeme Priddle with hands on work shops following. To see Graeme’s work see <http://graemepriiddle.com> .

September’s demonstrator is Avelino Samuel from St Johns, U.S. Virgin Isl. You can see examples of his carved and decorated hollow forms at the Gallery St Thomas web site <http://gallerystthomas.com/avelinosamuel.aspx> . Avelino is a teacher and has taught at the AAW symposiums. This is his first trip to the Northwest. On Wednesday Sept 14th, Avelino will do an all day demonstration at Dale's shop in Gresham. The cost will be \$30 per person. Thursday evening Avelino will be the demonstrator at our monthly chapter meeting at the Franklin High School.



Avelino Samuel hollow forms

CWT MENTORS

Cascade Wood Turners has a mentoring program and the member turners providing assistance are listed in the “Resources” section of the web page <http://www.cascadewoodturners.com/resources.htm>. These members are available for you to contact if you need help in different areas of woodturning. If you would like to be a mentor yourself and be contacted with woodturning related questions e-mail me at rgklug@crestviewcable.com and I will add you to the list!

QUICK LINKS:

There is a listing of web links used by club members in the “Resources” section of the web site <http://www.cascadewoodturners.com/resources.htm> . If you have a favorite or new site that would be useful to club members, e-mail it to me to include it with the list. rgklug@crestviewcable.com

COMPANY STORE

If a number of members want a certain item, and we are low on it please email Jerry Harris at westwoodct@comcast.net a week ahead, he could have it with no out of stock.

Note the price increase on walnut oil – still a good bargain Dale Larson has generously donated the bees wax from his old bee hives and we have seven bars left for \$2 per bar. Thanks Dale. Get them before they're gone.

The store will be open at the picnic. See you there.

Company Store Item	Price
Accelerator (for Cyanoacrylate adhesives/CA), sprayer, 8 oz	\$6.75 each
Anchor Seal, one gallon	\$12.50 each
Cyanoacrylate adhesives (CA) - Thin, Medium and Thick, 2oz bottles	\$5.75 each
Sandpaper, Aluminum oxide with heavy cotton cloth backing in 80, 100, 120, 180, 220, 320 & 400 grits	\$1.00 each sheet
Walnut Oil - filtered, 16 oz	\$4.00 each

CLASSIFIEDS

To place or continue an ad, contact Jerry Klug at rgklug@crestviewcable.com . We will run ads in the next newsletter after receiving your ad. Let us know if you want your ad continued more than one month.

For Sale: Oxy-acetylene tanks on stand. Bottles are empty. \$175.
Dayton 8" grinder. 3450 RPM. Excellent condition. \$150.
Call/email Howard at 503.658.3409 or howbor@yahoo.com

CASCADE WOODTURNERS SPONSORS

Support of the sponsors listed helps maintain our hobby supplies. Remember that your current membership card is good for discounts at these firms. For additional information see the website <http://www.cascadewoodturners.com/sponsors.htm> .

Gilmer Wood Company
KLINGSPOR Abrasives, Inc.
Rockler Woodworking & Hardware
Woodcraft Supply
Woodcrafters
Carbide Saw

CASCADE WOODTURNERS OFFICERS AND CONTACTS

President	David Williams	(503) 997-2541 dwilliams97007@yahoo.com
Vice President	Gary Sandquist	(503) 645-2231 GarySundquist@gmail.com
Treasurer	Howard Borer	(503) 658-3409 howbor@yahoo.com
Secretary	Ken Kirkman	(360) 687-9866 kenpegkirkman@gmail.com
Member at large	Skip Burke	(503) 233-4263 drgramp@comcast.net
Video Librarian	Dawn McClard	(503) 255-3940 dimclard@comcast.net
Book Librarian	Mike Worthington	(503) 640-0373 mikedw47@comcast.net
Company Storekeeper	Jerry Harris	(503) 244-6921 westwoodct@comcast.net
Newsletter Editor	Jerry Klug	(541) 550-6299 rgklug@crestviewcable.com

Here are some of the regulations for the Oregon State Fair Hobbies Competition: Oregon Parks and Recreation Department, through its Oregon State Fair (OPRD) offers hobby exhibits to compete for recognition that is open to Oregon residents only. For questions regarding the Hobbies Department, call (503) 947-3247 or e-mail Neva.Hutchinson@state.or.us. After July 25, call (503) 947-3293, or e-mail creative.living@state.or.us. See us at our web page, www.oregonstatefair.org.

Entries will be accepted that have not been exhibited within the last **four** years in the Hobbies Department. Entry forms are due by Aug. 5, 2011. Contact the above web site for entry forms (enter HOBBY in the search box and print the PDF).

Professionals, judges, instructors, advisors, owners/operators or demonstrators engaged in business related to this area of exhibit, or those who sell their items for more than cost, must enter Professional Division.

Hobby entries will be accepted Saturday, August 20, from **10:00 a.m. to 6:00 p.m.** at the **17th Street** entrance of the Americraft Cookware Center, State Fairgrounds. Doors will close and exhibitors will be asked to leave promptly at 6:00 p.m.

Hobby exhibits must be picked up Wednesday, September 7th between 1:00 p.m. and 6:00 p.m. **No exceptions will be made.**

Class 511 Wood

Lot 01-08 – **Woodturning**

- 01 Bowls
- 02 Platters
- 03 Pens
- 04 Boxes
- 05 Kitchen Utensils
- 06 Hollow Vessels
- 07 Christmas Ornaments
- 08 Innovative: Any turning which, by design is unique or does not fit into any of the above categories

Lot 09-23 – **Miscellaneous Woodworking**

- 09 Fantasy Carving
- 10 Wild Life Carving
- 11 Stylized Carving
- 12 Caricature Carving
- 13 Bark Carving
- 14 Carved Kitchen Utensils
- 15 Carving - Relief
- 16 Chip Carving
- 17 Marquetry
- 18 Wood burning
- 19 Intarsia
- 20 Fretwork
- 21 Wooden toys
- 22 Canes and walking sticks
- 23 Other